

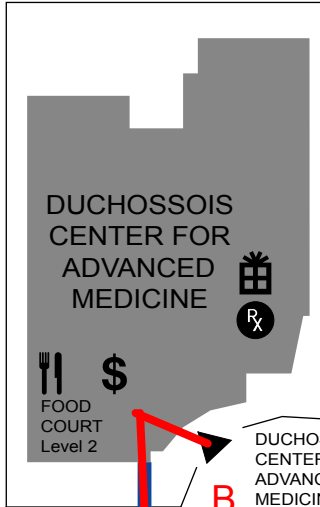

THE UNIVERSITY OF CHICAGO HOSPITALS

Red lines show route from: A) parking lot on corner of Cottage Grove and 58th Street; B) valet parking in the front of Duchossois Center (DCAM); and C) 59th Street entrance (closes at 3pm). For (A) and (B) you should walk on level 2, and for (C) you should walk on level 1 (ground floor) to the 'A West' elevator (circled) and take it up to the third floor. Check in is the doc immediately in front of the elevator (A336)

COTTAGE GROVE AVE.



B

DUCHOSSOIS CENTER FOR ADVANCED MEDICINE OUTPATIENT ENTRANCE

MARYLAND AVE.

COMER CHILDREN'S HOSPITAL ENTRANCE OPEN 24 HOURS



DREXEL AVE.

- J L MAIN ELEVATORS NOTED WITH LETTER
- OTHER ELEVATORS
- MAIN CORRIDORS
- LEVEL 2 BRIDGES / CORRIDORS
- GIFT SHOP
- CAFETERIA / FOOD COURT
- COFFEE SHOP
- ATM CASH STATION
- PHARMACY
- POST OFFICE
- BOOKSTORE



ELLIS AVE.

58th STREET



A

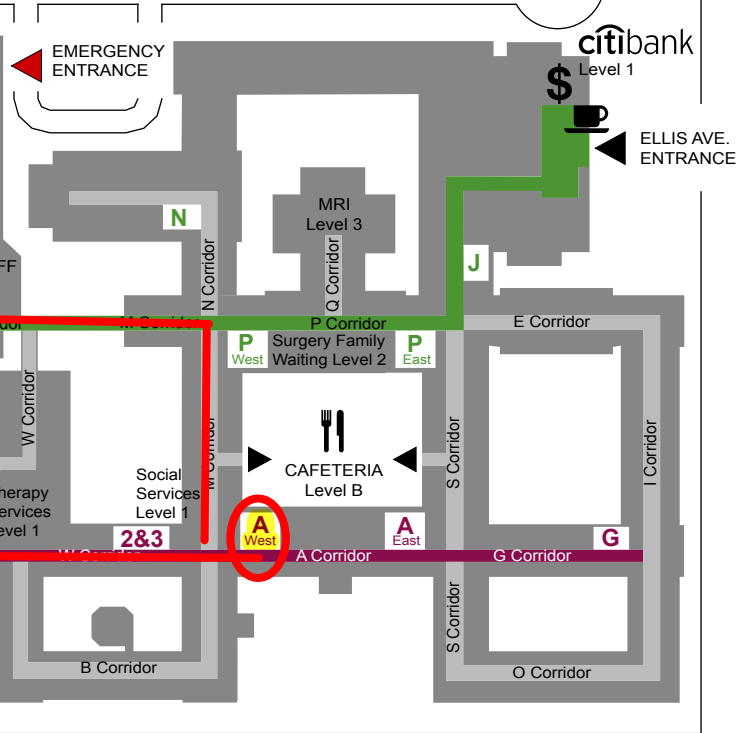
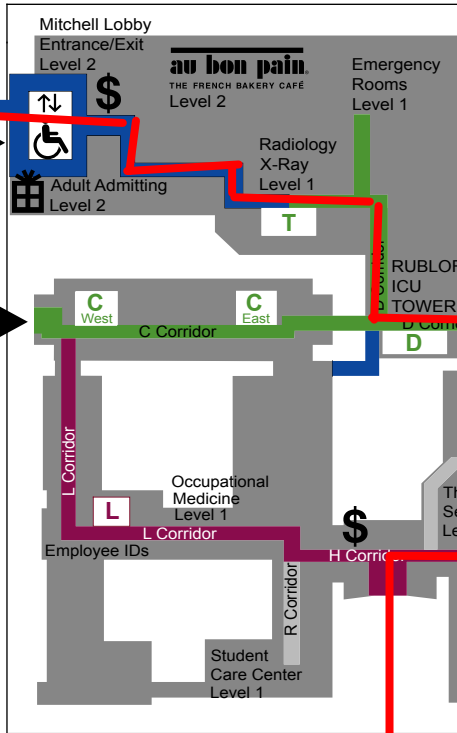

59th STREET

C